

austofix **Distal Humeral** 2.4, 2.7, 3.5mm L&C Plates

Product Brochure



austofix Distal Humeral

2.4, 2.7, 3.5mm L&C Plates

Plate Features

Anatomical Fit

- » Pre-contoured design for left and right distal lateral humerus
- » Tapered end assists in submuscular plate insertion and helps to minimise tissue trauma
- » Plate can be further contoured with Plate Benders for a more suitable anatomical fit

Distal Locking

- » Distal locking holes provide flexibility in Locking Screw fixation
- » Multiple points of fixation for superior support
- » Distal Lateral Dorsal Plates feature three distal holes for capitulum fixation

Plate Fixation

- » Combi-Holes along shaft of the Plate allow Locking Screw fixation for angular stability or Cortex/Cancellous Screws for dynamic compression
- » Gliding Combi-Holes facilitate plate positioning and repositioning
- » Distal Plate shaft has increased thickness for additional strength
- » Lateral extension for distal humeral fracture buttressing*

***Note:** Lateral Extension found on the Distal Lateral Dorsal Humeral Locking Plate (Buttress)

Two-Plate Fixation Method

- » Increased stability achieved through a combination of two Plates for improved distal humerus fracture fixation
- » Laterally fixed Plate for elbow flexion support & medially fixed Plate to support the medial aspect of the distal humerus
- » Lateral: Distal Lateral Dorsal Humeral Locking Plate
- » Medial: Distal Medial Humeral Locking Plate

Clinical Indications

- » Designed to address intra-articular and comminuted supracondylar fractures of the distal Humerus
- » Can be utilised for osteotomies and nonunions of the distal Humerus
- » Particularly beneficial for patients with osteopenic bone

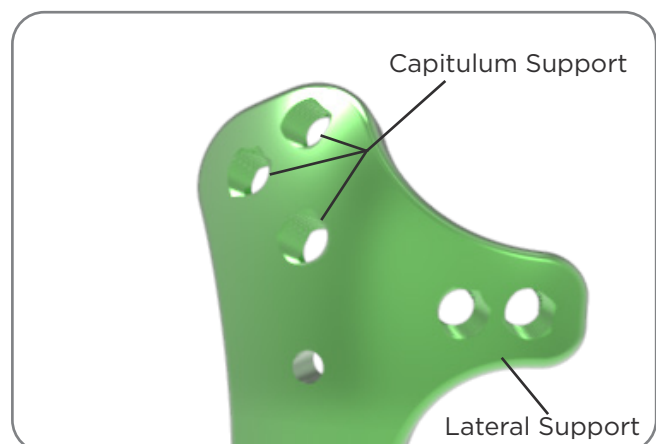
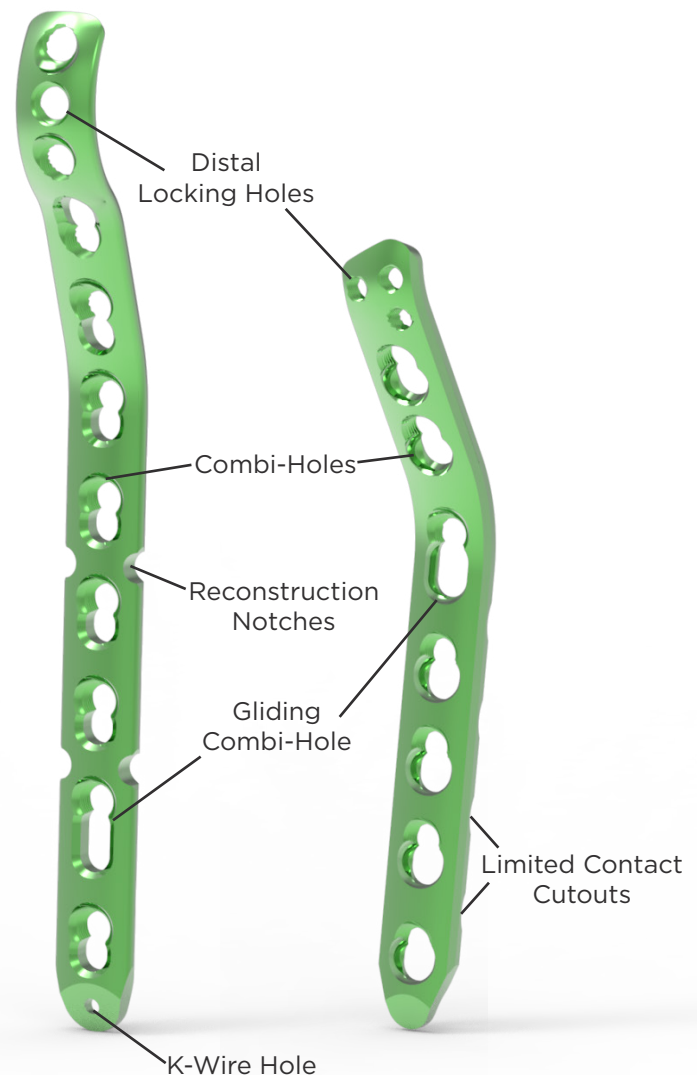

Implant Features

Combi Hole

The Combi Hole allows for a range of plate fixation options. The holes accommodate both Compression and Locking screws.

Slotted Hole - Cortex Screws/Cancellous Screws

- » Cortex or Cancellous Screws used in the slotted hole for plate-to-bone compression increases stability

Threaded Hole - Locking Screws

- » Locking screws link with the threads in the Threaded Hole, keeping the screw at a fixed angle

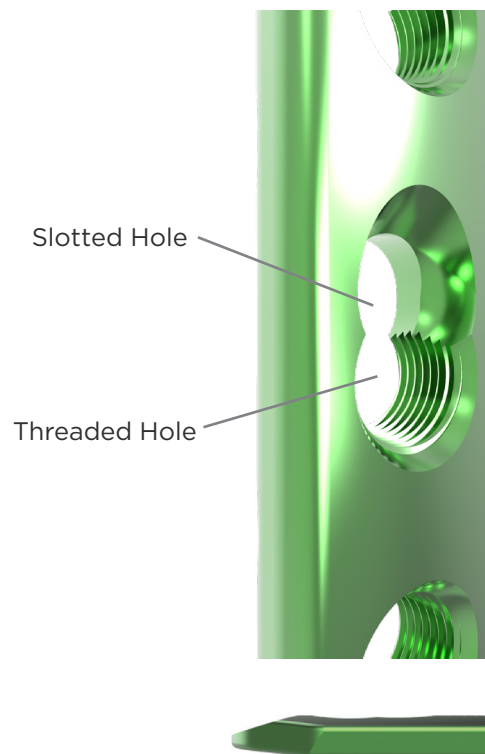

Tapered End

Tapered end assists in submuscular plate insertion and helps to minimise tissue trauma.

Screws

2.4, 2.7 & 3.5mm Locking Screws

- » Self-Tapping for ease of insertion & reduced procedure duration
- » Special thread design resulting in reduced Screw back-out
- » Unicortical or bicortical fixation for flexibility in fracture fixation

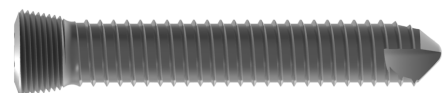

2.4 & 3.5mm Cortex Screws

- » Utilised for dynamic axial compression within the smooth, slotted holes of the Combi-Holes
- » Can be used to provide plate-to-bone compression
- » Rounded head allows for angulated insertion

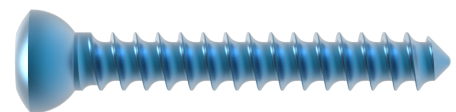

4.0mm Cancellous Screws

- » Utilised for dynamic axial compression within the smooth, slotted holes of the Combi-Holes
- » Can be used to provide plate-to-bone compression
- » Partially-Threaded Cancellous Screws assist with interfragmentary compression

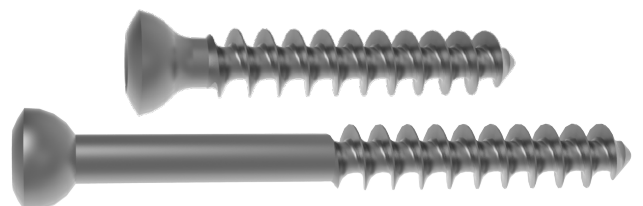

3.5mm Spacer

- » Reduces plate-to-bone contact, minimising disruption of periosteal blood supply

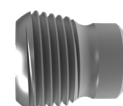

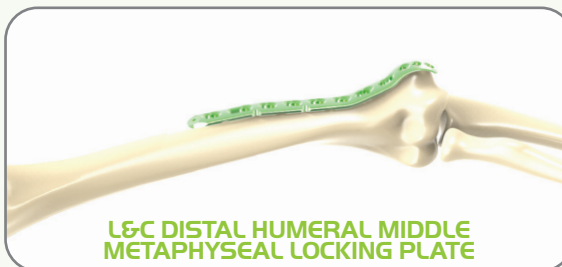
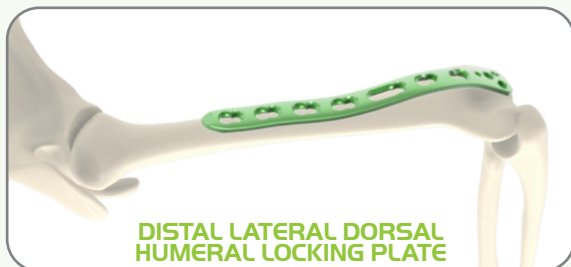

As a leading manufacturer and designer of orthopaedic medical devices Austofix is dedicated to continuous innovation, excellence and patient safety.

Austofix has extensive experience and expertise in developing new medical devices from concept to a fully commercialised product with regulatory approval for worldwide distribution. With a team of world-class research and development specialists Austofix identifies emerging techniques and innovations within the field of orthopaedic to develop world-class solutions.

By focussing on the specific needs of orthopaedic surgeons, Austofix products assist the surgeon in performing accurately, efficiently and safely leading to better health outcomes for the patient. Austofix success can be measured through the excellent clinical results and positive surgeon feedback.

This has led to Austofix emerging as one of Australia's key contributors to the world-wide medical technology industry.

Legal Manufacturer

Australian Orthopaedic Fixations Pty Ltd
18 Kinkaid Avenue, North Plympton SA 5037, AUSTRALIA

Telephone: 1300 727 075

Fax: 1300 727 380

Email: sales@austofix.com.au



DISTRIBUTOR STICKER

