

# austofix Proximal Humeral 3.5mm L&C Plates

## Product Brochure

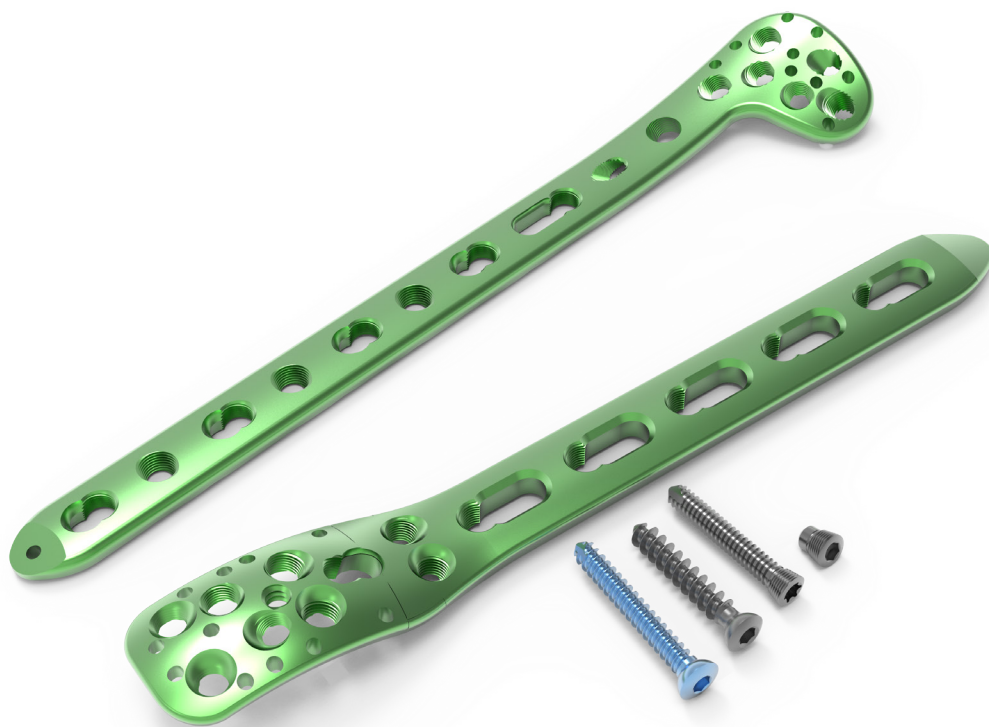

# austofix Proximal Humeral 3.5mm L&C Plates - Features

The Austofix Proximal Humeral Locking Plates are designed for the fixation of the many fracture patterns found in the proximal humerus. Implant grade Titanium Plates and Screws incorporate significant benefits: lightweight, high strength and biocompatible.

## Anatomical Fit

- » L&C Proximal Humeral Plate universally designed for left and right proximal humerus
- » L&C Proximal Humeral Greater Tubercle Plate is available in left and right proximal humerus configurations
- » Tapered end assists in submuscular plate insertion and helps to minimise tissue trauma
- » Plate can be contoured with Plate Benders for a more suitable anatomical fit

## Humeral Head Locking

- » Proximal locking holes provide flexibility in Locking Screw fixation
- » Multiple points of fixation for improved Humeral Head support
- » Diverging and converging Locking Screw patterns can be achieved

## Plate Fixation

- » Multiple K-Wire/Suture holes surrounding the proximal construct of the Plate allows for provisional fixation and Plate alignment
- » Combi-Holes along distal shaft of the Plate for locking and compression
- » Gliding Combi-Hole allows repositioning of plate for axial compression flexibility
- » Distal Plate shaft has increased thickness for additional strength

## Clinical Indications

- » Can be utilised for osteotomies and nonunions of the proximal Humerus
- » Particularly beneficial for patients with osteopenic or osteoporotic bone

### L&C Proximal Humeral Locking Plate

- » Designed to address complex dislocated two-, three- and four-part fractures of the proximal Humerus

### L&C Proximal Humeral Greater Tubercle Locking Plate

- » Designed to address complex fractures of the proximal humerus
- » Greater Tubercle Buttress support for fracture stabilising

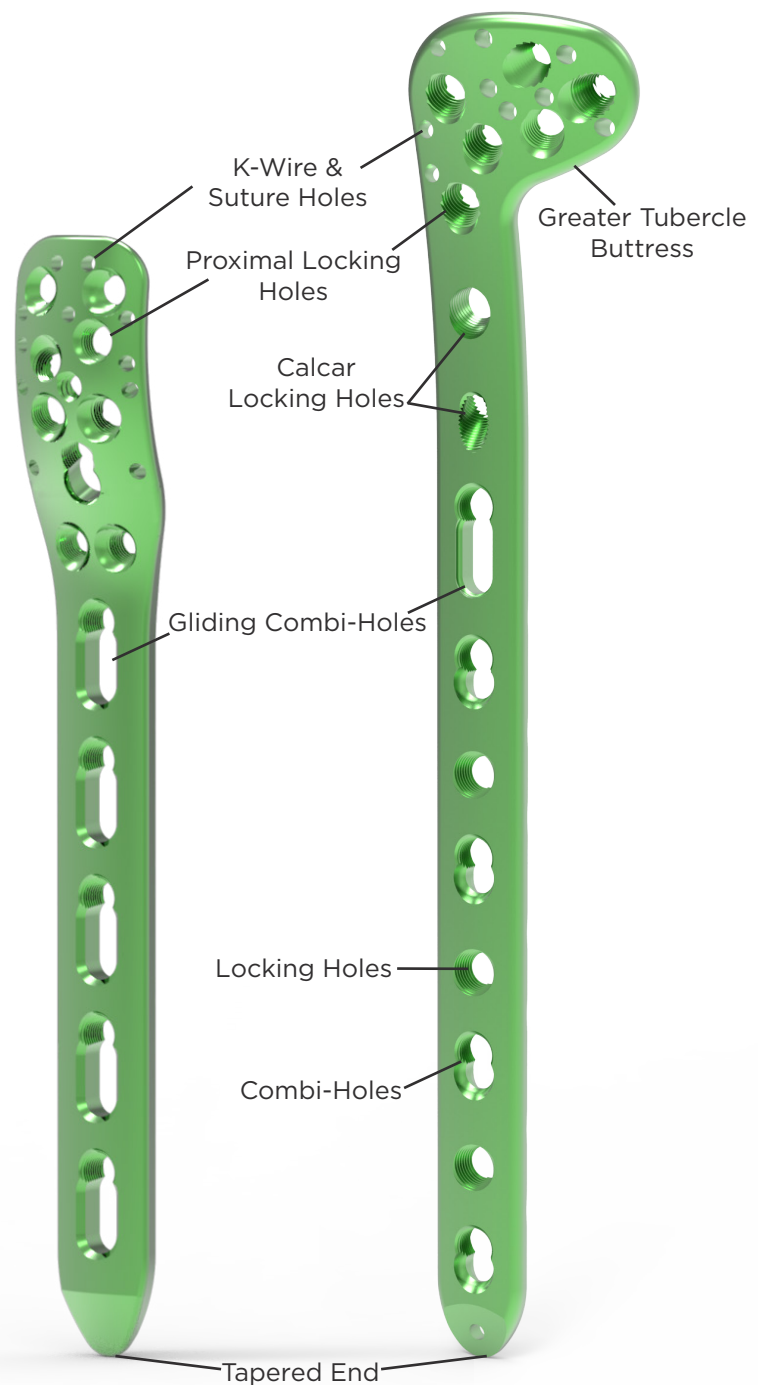

# Implant Features

## Combi Hole

The Combi Hole allows for a range of plate fixation options. The holes accommodate both Compression and Locking screws.

### Slotted Hole - Cortex Screws/Cancellous Screws

- » Cortex or Cancellous Screws used in the slotted hole for plate-to-bone compression increases stability

### Threaded Hole - Locking Screws

- » Locking screws link with the threads in the Threaded Hole, keeping the screw at a fixed angle

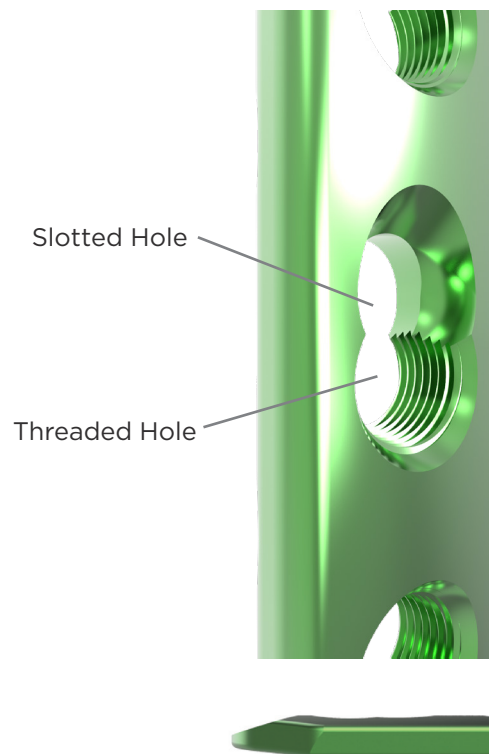

## Tapered End

Tapered end assists in submuscular plate insertion and helps to minimise tissue trauma.

## Screws

### 3.5mm Locking Screws

- » Self-Tapping for ease of insertion & reduced procedure duration
- » Special thread design resulting in reduced Screw back-out
- » Unicortical or bicortical fixation for flexibility in fracture fixation

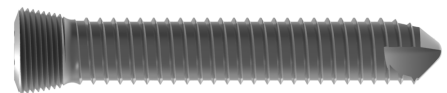

### 3.5mm Cortex Screws

- » Utilised for dynamic axial compression within the smooth, slotted holes of the Combi-Holes
- » Can be used to provide plate-to-bone compression
- » Rounded head allows for angulated insertion

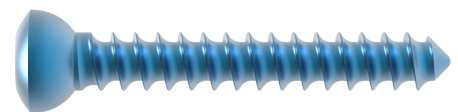

### 4.0mm Cancellous Screws

- » Utilised for dynamic axial compression within the smooth, slotted holes of the Combi-Holes
- » Can be used to provide plate-to-bone compression
- » Partially-Threaded Cancellous Screws assist with interfragmentary compression

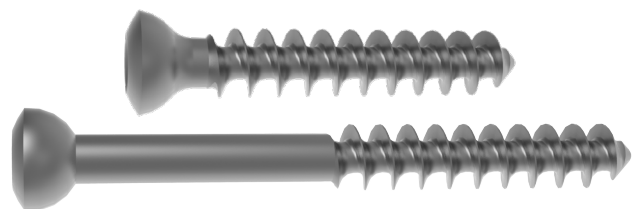

### 3.5mm Spacer

- » Reduces plate-to-bone contact, minimising disruption of periosteal blood supply

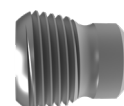

## PROXIMAL HUMERAL LOCKING PLATE

- » Universal Design
- » 3 to 13 Combi-Hole Options
- » Screw Compatibility:
  - » Ø3.5mm Cortex Screw
  - » Ø4.0mm Cancellous Screw
  - » Ø3.5mm Locking Screw
  - » Ø3.5mm Spacer

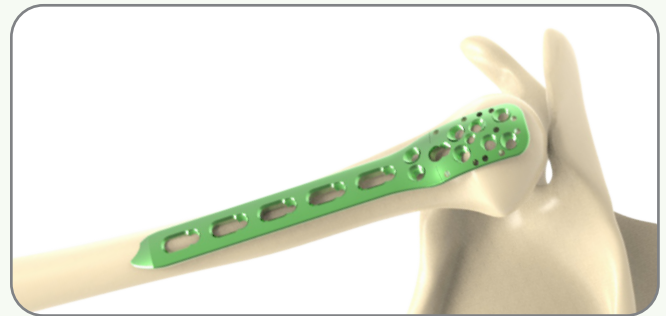

## PROXIMAL HUMERAL GREATER TUBERCLE LOCKING PLATE

- » Left & Right Humeral Designs
- » Greater Tubercle Extension for Buttressing
- » 2 to 16 Combi-Hole Options
- » Screw Compatibility:
  - » Ø3.5mm Cortex Screws
  - » Ø4.0mm Cancellous Screw
  - » Ø3.5mm Locking Screws
  - » Ø3.5mm Spacer



As a leading manufacturer and designer of orthopaedic medical devices Austofix is dedicated to continuous innovation, excellence and patient safety.

Austofix has extensive experience and expertise in developing new medical devices from concept to a fully commercialised product with regulatory approval for worldwide distribution. With a team of world-class research and development specialists Austofix identifies emerging techniques and innovations within the field of orthopaedic to develop world-class solutions.

By focussing on the specific needs of orthopaedic surgeons, Austofix products assist the surgeon in performing accurately, efficiently and safely leading to better health outcomes for the patient. Austofix success can be measured through the excellent clinical results and positive surgeon feedback.

This has led to Austofix emerging as one of Australia's key contributors to the world-wide medical technology industry.

### Legal Manufacturer

Australian Orthopaedic Fixations Pty Ltd  
18 Kinkaid Avenue, North Plympton SA 5037, AUSTRALIA

Telephone: 1300 727 075  
Fax: 1300 727 380  
Email: [sales@austofix.com.au](mailto:sales@austofix.com.au)



DISTRIBUTOR STICKER